	Preliminary	Collimator Lens
SP-LENS-15		

Features

- Collimate the light source
- 15° viewing angle
- Optical grade plastic

Typical Application

- CCD lighting
- Night vision light source
- Other aids lighting

■ Mechanical Outline Dimensions

General Tolerance: +/-0.1

Outline Dimension :

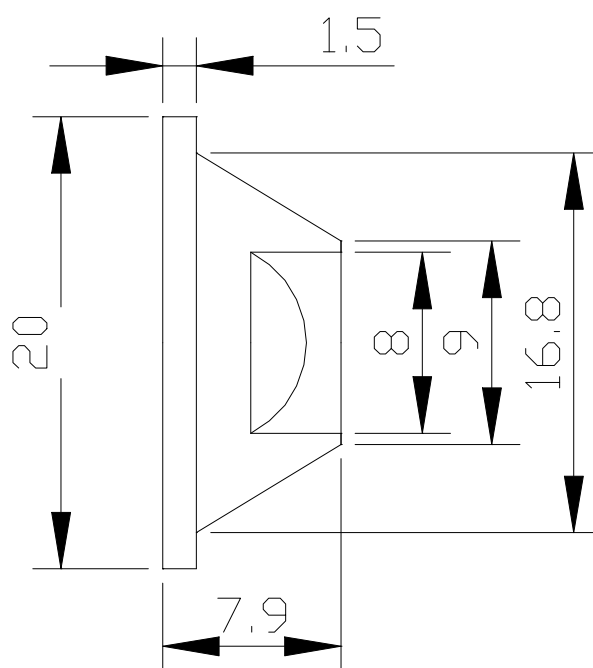

Soldering terminals may shift in x, y direction.

Unit: mm

Specifications are subject to changes for improvement without advance notice.

Caution: This product specification is a TENTATIVE EDITION. Its mechanical dimension, layout and electro-optical properties may be revised to improve product quality and reliability.

12-21-2004

Version of 1.0

Page 1/2

■ Radiation Pattern

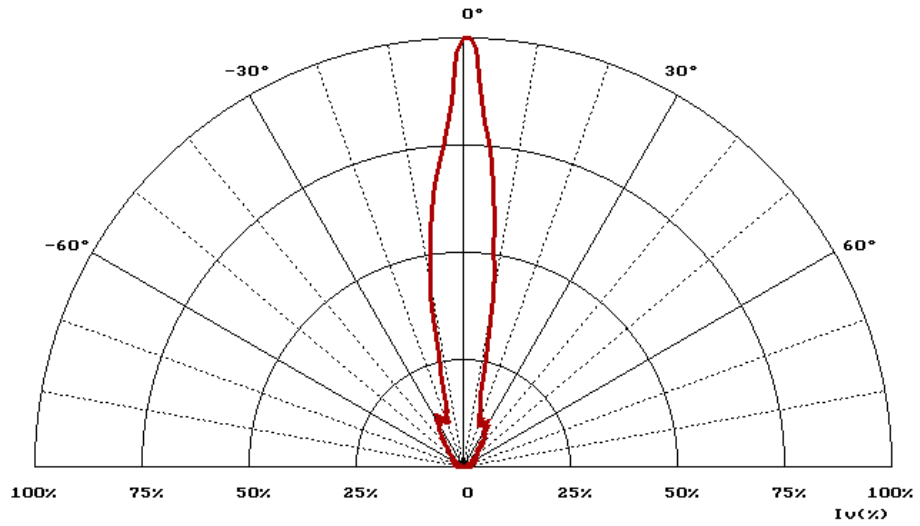

Specifications are subject to changes for improvement without advance notice.
Caution: This product specification is a **TENTATIVE EDITION**. Its mechanical dimension, layout and electro-optical properties may be revised to improve product quality and reliability.

12-21-2004

Version of 1.0

Page 2/2